

X-1000U Specification

1、 The size and the weight of main body

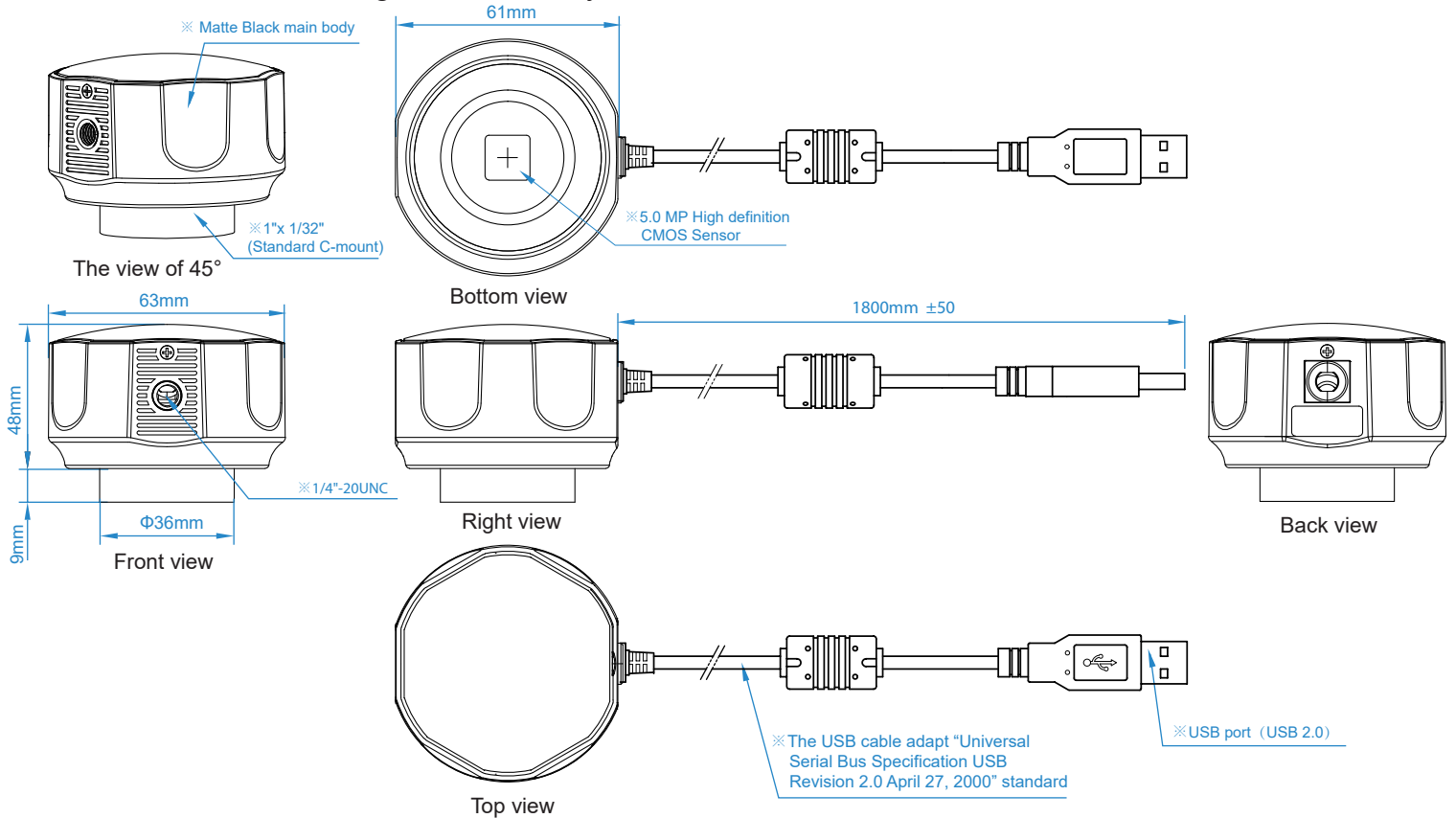

X-1000U (Body net weight about 128g)

2、 Electrical property

Hardware configuration	
Image Sensor	Colorful
Scan Mode	Scan line by line
Maximum Resolution	2592 x 1944(5,038,848 pixels)
Sensor Optical Format	1/2.5 " (5.70mm(H) x 4.28mm(V), Diagonal 7.13mm)
Pixel Size	2.2 μm x 2.2 μm
Dynamic Range	70.1dB
ADC	12-bit, 8-Bit R.G.B to PC
SNR (Signal Noise Ratio)	38.1dB
Spectral Characteristics	380-650nm
Preview Modes	10FPS@2592x1944, 15FPS@1920x1080, 1600x1200 40FPS@1280x960, 1280x720, 1024x768, 800x600, 640x480
Binning Modes	1 x 1, 2 x 2
Exposure Capability	3.9ms - 320ms, Automatic and manual
White Balance	Automatic and manual
Software Interface	DirectShow
Capture Modes	Picture Resolution: 2592x1944, 1920x1080, 1600x1200, 1280x960, 1280x720, 1024x768, 800x600, 640x480 Format: JPG,BMP,PNG,TIFF,PDF Video Resolution: 1920x1080, 1600x1200, 1280x960, 1280x720, 1024x768, 800x600, 640x480 Format: MJPG format AVI file
Software Environment	
Operation system	Microsoft® Windows® XP / 7 / 8 / 8.1/10(32 & 64 bit)
Computer Configuration	CPU: equal or more than the second generation Intel core 2.8GHz
	Memory : 2G or more
	USB port : USB2.0 high speed port or compatible port
	Displayer : suggest 17 inches or larger
Operating Environment	
Operating Temperature	0°C~ 40°C
Storage Temperature	-20°C~ 60°C
Operating Humidity	10~60%RH
Storage Humidity	30~80%RH
Power supply	Direct-current , supply by USB port

3、 Standard Configuration

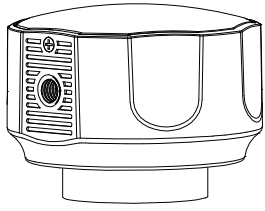

PC software:
Kopa Capture above ver 6.0
Operation instruction

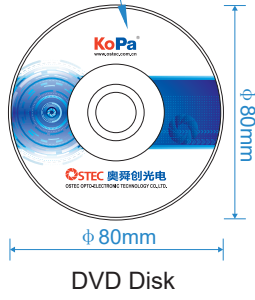

5895 Rue Ferrari San Jose, CA 95138
1 (800) 832-0060 | Fax: (408) 226-0900
www.meijitechno.com